

III

KEY PLAN for Phase I – Final Proposed Project Master Plan, October 10, 2011

- Exhibit A** - MSE System Along Moraga
- Exhibit B** - Typical Street Tree Detail
- Exhibit C** - Roundabout at Maxwelton and Moraga
- Exhibit D** - Restroom Building for Phase I
- Exhibit E** - Bioswale Location and Concept
- Exhibit F** - Pedestrian Crossing at Red Rock

The following architectural renderings are included for clarification and support of the documents included under I, II and III, Exhibits A – B.

***View A** – View of original berm design, as proposed under the final certified EIR, with retaining walls and no sidewalk along Moraga.*

***View B** – View of proposed berm with MSE vegetated system (as described under Exhibit B) and new sidewalk along Moraga. Fence height reduced from 20 feet to 15 feet in height and concrete retaining wall along Moraga eliminated.*

***View C** – View of proposed Phase I project development, as depicted in the Phase I - Final Proposed Project Master Plan, August 25, 2011.*

***View D** – View of proposed Phase I project development including, the public safety parking space, the new baseball diamond at the NE corner of the large soccer field and the Phase I restroom building in the distance, as depicted in the Phase I – Final Proposed Project Master Plan, August 25, 2011.*

ADDITIONAL DETAILED INFORMATION

EXHIBIT A - MSE SYSTEM ALONG MORAGA
 EXHIBIT B - TYPICAL STREET TREE DETAIL
 EXHIBIT C - ROUNDABOUT AT MAXWELTON AND MORAGA
 EXHIBIT D - RESTROOM BUILDING FOR PHASE I
 EXHIBIT E - BIOSWALE LOCATION AND CONCEPT
 EXHIBIT F - PEDESTRIAN CROSSING AT RED ROCK

VIEW A - VIEW OF ORIGINAL BERM DESIGN WITH RETAINING WALLS AND NO SIDEWALK ALONG MORAGA.

VIEW B - VIEW OF PROPOSED BERM WITH MSE VEGETATED SYSTEM AND NEW SIDEWALK ALONG MORAGA. FENCE HEIGHT REDUCED FROM 20 FEET TO 15 FEET IN HEIGHT AND CONCRETE RETAINING WALL ALONG MORAGA ELIMINATED.

VIEW C - VIEW OF PHASE I PROJECT DEVELOPMENT (GLADE NOT DEVELOPED).

VIEW D - VIEW OF PHASE I PROJECT DEVELOPMENT INCLUDING THE PUBLIC SAFETY PARKING SPACE, THE NEW BASEBALL DIAMOND AT THE NE CORNER OF THE LARGE SOCCER FIELD AND THE PHASE I RESTROOM BUILDING IN THE DISTANCE.

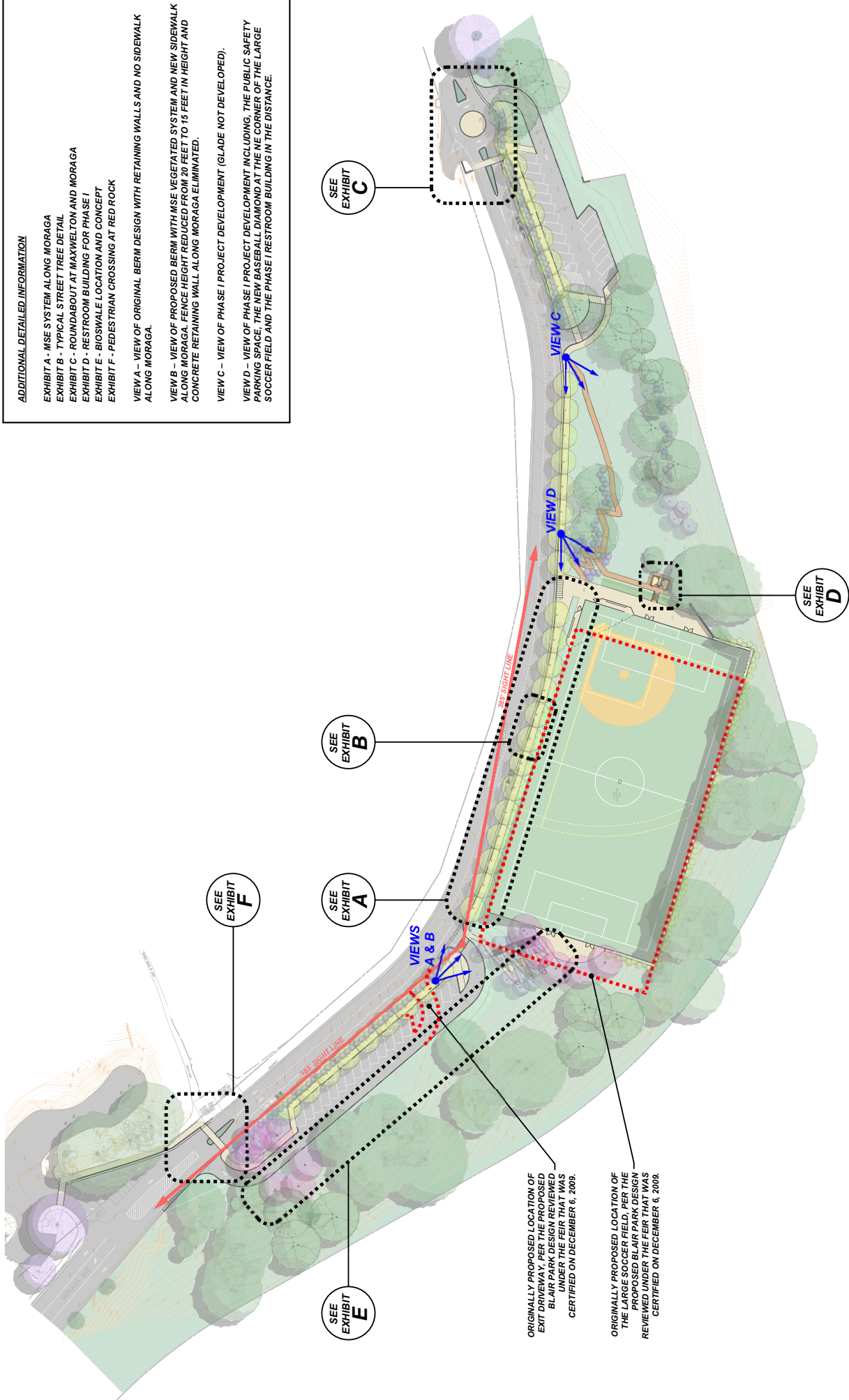

ORIGINALLY PROPOSED LOCATION OF EXIT DRIVEWAY, PER THE PROPOSED BLAIR PARK DESIGN REVIEWED UNDER THE FEIR THAT WAS CERTIFIED ON DECEMBER 6, 2009.

ORIGINALLY PROPOSED LOCATION OF THE LARGE SOCCER FIELD, PER THE PROPOSED BLAIR PARK DESIGN REVIEWED UNDER THE FEIR THAT WAS CERTIFIED ON DECEMBER 6, 2009.